

RoHS

REV.	ECN.NO.	APPD.
AO	NEW DWG	LJF

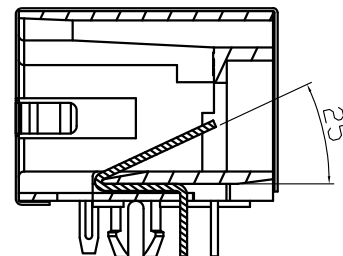
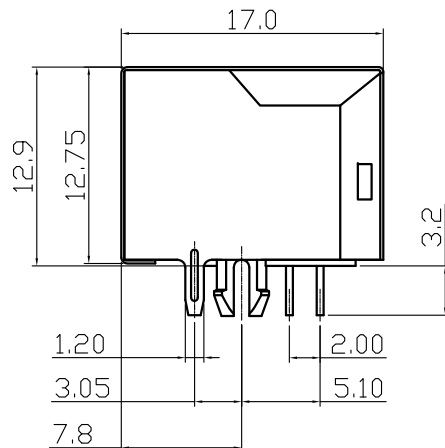
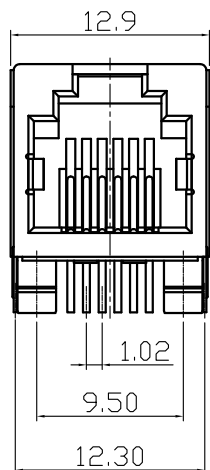

NOTES:

- 1.MATERIAL:
 - 1.1 Housing:thermoplastic plastics
 - 1.2 terminals:Copper Alloy
Gold plated in contact area:
OR Gold Plated overall
 - 1.3 Shell:Steel&Copper Alloy
Nickel/Tin Plated overall
- 2.ELECTRICAL CHARACTERISTICS:
 - 2.1 Rating Current :1.5 Ampere
 - 2.2 Rating Voltage :125 V Max
 - 2.3 Contact Resistance:50 Milli ohms
 - 2.4 Insulation Resistance:500 Mega ohms Min.
- 3.MECHANICAL CHARACTERISTICS:
 - 3.1 Connector Mating force: 2.27kgf MAX
 - 3.2 Durability:750Cycles.
- 4.ENVIRONMENT CHARACTERISTICS:
 - 4.1 Operating temperature:-40°C to +85°C
 - 4.2 Storage temperature:-10°C to +40°C

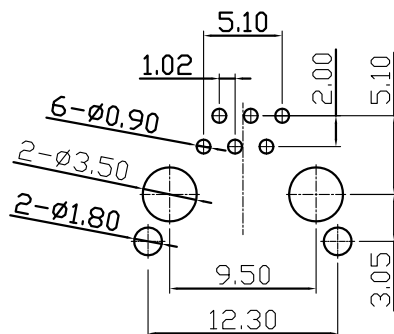
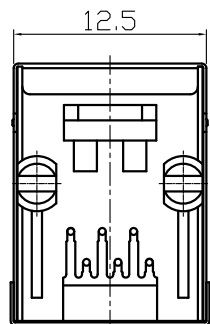

Recommend PCB Layout
(Jack Top View)
Tolerance: ±0.05mm
Recommend PCB Thickness: 1.6mm

- R11120-100G08
- 1: 铜壳镀镍
 - 8: 防火
 - G: C5191半金G/Fu
 - 0: PBT黑色

TOLERANCE UNLESS OTHERWISE SPECIFIED		HLW 深圳市华联威电子科技有限公司 HUA LIAN WEI TECHNOLOGY ELECTRONICS CO.;LTD.			
.XXX ±0.10	.XX ±0.20	.X ±0.30	.X' ±3'	.XX' ±2'	
APPROVED		PART NAME:	RJ11 6P6C 带屏蔽无弹		
CHECKED		PART No:	R11120-100G08		C
DRAWN	Deng Shan	PROJECTION:	UNIT:	SCALE	SHEET
DATE	2020.08.17		mm	1:1	10F1
					REV. AO

SHELL	1	BRASS T=0.2mm	Ni PALTING	
TERMINAL	6	PHOSPHOR BRONZE Ø0.46	Au PALTING	
HOUSING	1	PBT UL94V-0	BLACK	
PART NAME	QTY	MATERIAL	PLATING & COLOR	Remark